

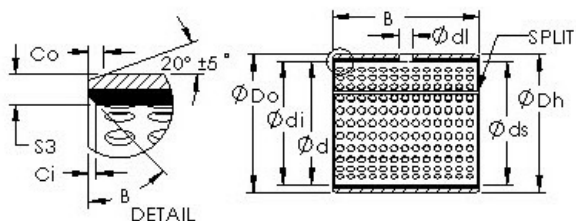

# BEARING SCIENCE & TECHNOLOGY CO.,LTD.



## AST AST20 22080 plain bearings

Bearing No. AST20 22080

Bore Diameter	220 mm
Outer Diameter	225 mm
Bearing Type	straight
Shaft Dia., Nominal (d)	220.0000
Shaft Size (ds) - 220 +0 / -0.072	220 +0 / 0.072
Housing Bore Dia. (Dh) - 225 +0.046 / -0	225 +0.046 / 0
Bearing Outside Diameter, Nominal(Do)	225.000
Bearing Outside Diameter Tolerance (Do tol.)	225.210 / 225.130
Bearing Bore after Mounting (di)	220.276 / 220.110
Average Clearance (Cd)	0.2250
Wall Thickness (S3)	2.418
Bearing Length, Nominal (B)	80.000
Bearing Length Tolerance (B tol.) - +0 / -0.40	+0 / 0.40
OD Chamfer Length (Co)	1.800
ID Chamfer Angle (B deg.)	45
ID Chamfer Length (Ci)	0.800
Lube Hole Dia. (dl)	9.500
Material	Carbon steel shell with POM plastic liner

AST20 22080 Bearing 2D drawings and 3D CAD models