

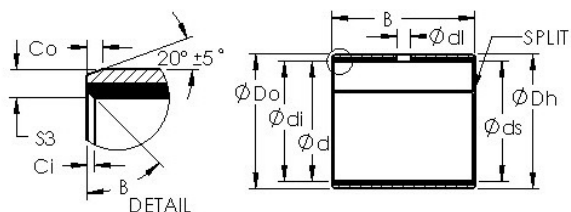

# BEARING SCIENCE & TECHNOLOGY CO.,LTD.



## AST AST50 16IB16 plain bearings

Bearing No. AST50 16IB16

Bore Diameter	25,4 mm
Bearing Type	straight
Shaft Dia., Nominal (d)	1.0000
Shaft Size (ds) - 0.9991	0.9979
Housing Bore Dia. (Dh) - 1.1255	1.1247
Bearing Bore after Mounting (di) - 1.0025	0.9993
Average Clearance (Cd)	0.0024
Wall Thickness (S3)	0.063
Bearing Length, Nominal (B)	1.000
Bearing Length Tolerance (B tol.) - +.010 / -0.010	+0.010 / 0.010
OD Chamfer Length (Co)	0.026
ID Chamfer Angle (B deg.)	30
ID Chamfer Length (Ci)	0.019
Material	Carbon steel shell with PTFE / Fiber lining

AST50 16IB16 Bearing 2D drawings and 3D CAD models