

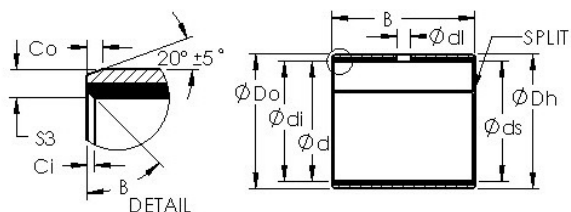

# BEARING SCIENCE & TECHNOLOGY CO.,LTD.



## AST AST11 2510 plain bearings

Bearing No. AST11 2510

Bore Diameter	25 mm
Outer Diameter	28 mm
Bearing Type	straight
Shaft Dia., Nominal (d)	25.0000
Shaft Size (ds) - 25 -0.02 / -0.041	25 0.02 / 0.041
Housing Bore Dia. (Dh)	28 +0.021 / +0
Bearing Outside Diameter, Nominal(Do)	28.000
Bearing Outside Diameter Tolerance (Do tol.)	28.075 / 28.035
Bearing Bore after Mounting (di)	25.071 / 24.99
Average Clearance (Cd)	0.0610
Wall Thickness (S3)	1.505
Bearing Length, Nominal (B)	10.000
Bearing Length Tolerance (B tol.) - +0 / -0.30	+0 / 0.30
OD Chamfer Length (Co)	0.700
ID Chamfer Angle (B deg.)	30
ID Chamfer Length (Ci)	0.500
Material	Bronze shell with PTFE / Fiber lining

AST11 2510 Bearing 2D drawings and 3D CAD models