

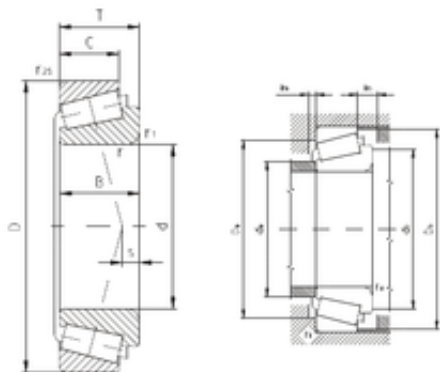

ZVL PLC64-8 tapered roller bearings



Bearing No. PLC64-8

Size	31.75x59.131x15.875 mm
Bore Diameter	31.75 mm
Outer Diameter	59,131 mm
Width	15,875 mm
d	31.75 mm
D	59,131 mm
T	15,875 mm
B	16,764 mm
C	11,811 mm
r min.	4,75 mm
r1 min.	3,56 mm
r2 min.	1,3 mm
S	2,9 mm
da max	38 mm
Da min	51 mm
Da max.	52 mm
db min	44,5 mm
Db min.	55 mm
ra max.	3 mm
rb max.	1 mm
Weight	0,18 Kg
Basic dynamic load rating (C)	35,8 kN
Basic static load rating (C0)	41,3 kN
(Grease) Lubrication Speed	6 700 r/min
(Oil) Lubrication Speed	8 900 r/min
Calculation factor (e)	0,41

PLC64-8 Bearing 2D drawings and 3D CAD models



BEARING SCIENCE & TECHNOLOGY CO.,LTD.

Calculation factor (Y)	1,5
------------------------	-----