

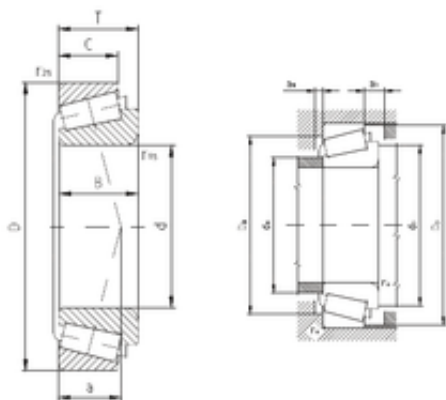

ZVL 32924A tapered roller bearings



32924A Bearing 2D drawings and 3D CAD models

Bearing No. 32924A

| | |
|-------------------------------|---------------|
| Size | 120x165x29 mm |
| Bore Diameter | 120 mm |
| Outer Diameter | 165 mm |
| Width | 29 mm |
| d | 120 mm |
| D | 165 mm |
| T | 29 mm |
| B | 29 mm |
| C | 23 mm |
| a | 29 mm |
| r1 min. | 1,5 mm |
| r2 min. | 1,5 mm |
| da max | 128 mm |
| Da min | 154 mm |
| Da max. | 158 mm |
| db min | 127 mm |
| Db min. | 160 mm |
| ra max. | 1,5 mm |
| Weight | 1,82 Kg |
| Basic dynamic load rating (C) | 166 kN |
| Basic static load rating (C0) | 305 kN |
| (Grease) Lubrication Speed | 1 900 r/min |
| (Oil) Lubrication Speed | 2 600 r/min |
| Calculation factor (e) | 0,35 |
| Calculation factor (Y) | 1,7 |