

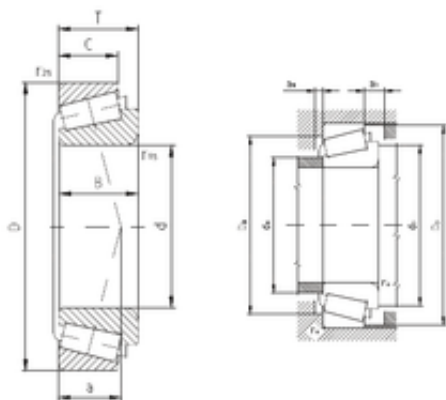

ZVL 32213A tapered roller bearings



32213A Bearing 2D drawings and 3D CAD models

Bearing No. 32213A

| | |
|-------------------------------|-----------------|
| Size | 65x120x32.75 mm |
| Bore Diameter | 65 mm |
| Outer Diameter | 120 mm |
| Width | 32,75 mm |
| d | 65 mm |
| D | 120 mm |
| T | 32,75 mm |
| B | 31 mm |
| C | 27 mm |
| a | 28 mm |
| r1 min. | 2 mm |
| r2 min. | 1,5 mm |
| da max | 75 mm |
| Da min | 105 mm |
| Da max. | 111 mm |
| db min | 74 mm |
| Db min. | 115 mm |
| ra max. | 1,5 mm |
| Weight | 1,66 Kg |
| Basic dynamic load rating (C) | 156 kN |
| Basic static load rating (C0) | 200 kN |
| (Grease) Lubrication Speed | 3 000 r/min |
| (Oil) Lubrication Speed | 4 000 r/min |
| Calculation factor (e) | 0,41 |
| Calculation factor (Y) | 1,5 |