

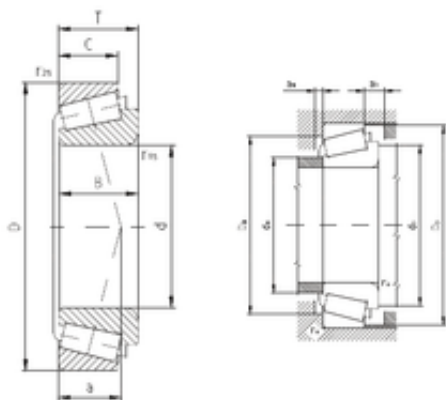

ZVL 30212A tapered roller bearings



Bearing No. 30212A

Size	60x110x23.75 mm
Bore Diameter	60 mm
Outer Diameter	110 mm
Width	23,75 mm
d	60 mm
D	110 mm
T	23,75 mm
B	22 mm
C	19 mm
a	23 mm
r1 min.	2 mm
r2 min.	1,5 mm
da max	69 mm
Da min	95 mm
Da max.	101 mm
db min	69 mm
Db min.	105,5 mm
ra max.	1,5 mm
Weight	0,916 Kg
Basic dynamic load rating (C)	102 kN
Basic static load rating (C0)	117 kN
(Grease) Lubrication Speed	3 300 r/min
(Oil) Lubrication Speed	4 500 r/min
Calculation factor (e)	0,41
Calculation factor (Y)	1,5

30212A Bearing 2D drawings and 3D CAD models