

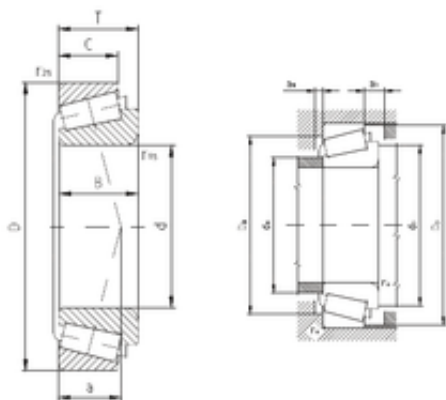

ZVL 32020AX tapered roller bearings



Bearing No. 32020AX

Size	100x150x32 mm
Bore Diameter	100 mm
Outer Diameter	150 mm
Width	32 mm
d	100 mm
D	150 mm
T	32 mm
B	32 mm
C	24 mm
a	33 mm
r1 min.	2 mm
r2 min.	1,5 mm
da max	109 mm
Da min	134 mm
Da max.	141 mm
db min	109 mm
Db min.	144 mm
ra max.	1,5 mm
Weight	1,94 Kg
Basic dynamic load rating (C)	178 kN
Basic static load rating (C0)	285 kN
(Grease) Lubrication Speed	2 400 r/min
(Oil) Lubrication Speed	3 200 r/min
Calculation factor (e)	0,46
Calculation factor (Y)	1,3

32020AX Bearing 2D drawings and 3D CAD models